

Wiring Accessories



- Dimensions are for reference only.
- All sizes are subject to change without prior notice.
- User shall determine the suitability of the product for his intended use.

Micro Plastics, Inc. <http://www.microplastics.com>
#1 Industry Lane • Hwy. 178 North • P.O. Box 149 • Flippin, Arkansas 72634

Nylon Cable Ties

- Manufactured from tough, durable Nylon 6/6 material which is self extinguishing to U.L. 94V2.
- The Nylon is inert to fungus or mold and is resistant to petrols, oil, grease and alkalis, etc.
- Ties can be tensioned by hand or by the use of applied tensioning tools.
- PARTS ARE PACKAGED 100 PIECES PER BAG • PURCHASE IN PACKAGED QUANTITIES ONLY
- MEETS THE REQUIREMENT OF MIL-S-23190E

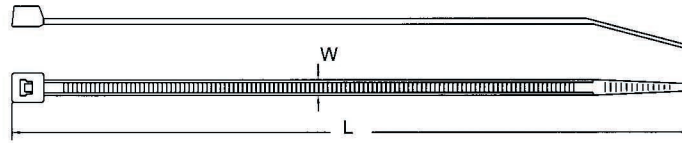
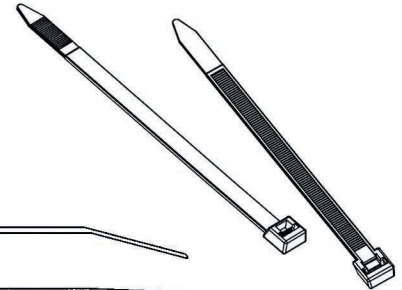
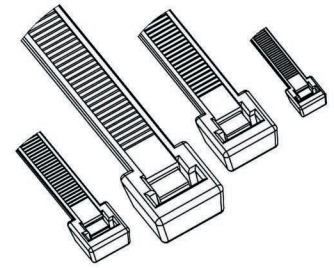

Details in
E 97527



E-4988



14515-99HH



ITEM NO.		LENGTH		WIDTH		MAX. DIAMETER		MAX. STRENGTH		RANGE
NATURAL	UV BLACK	STD	METRIC	STD	METRIC	STD	METRIC	STD	METRIC	
NT08025C	NT08025CB	2.95"	75mm	.094"	2.4mm	.71"	18mm	18lb	8.1kg	MINIATURE
NT10025C	NT10025CB	3.94"	100mm	.098"	2.5mm	.98"	25mm	18lb	8.1kg	
NT16025C	NT16025CB	6.50"	165mm	.098"	2.5mm	1.73"	44mm	18lb	8.1kg	
NT20025C	NT20025CB	7.99"	203mm	.098"	2.5mm	2.16"	55mm	18lb	8.1kg	INTERMEDIATE
NTA12032C	NTA12032CB	4.75"	120mm	.126"	3.2mm	1.18"	30mm	40lb	18kg	
NT14036C	NT14036CB	5.59"	142mm	.126"	3.2mm	1.38"	35mm	40lb	18kg	
NT20036C	NT20036CB	7.99"	203mm	.126"	3.2mm	2.16"	55mm	40lb	18kg	STANDARD
NTA12048C	NTA12048CB	4.72"	120mm	.189"	4.8mm	1.18"	30mm	50lb	22kg	
NT16048C	NT16048CB	6.30"	160mm	.189"	4.8mm	1.65"	42mm	50lb	22kg	
NT18048C	NT18048CB	7.48"	190mm	.189"	4.8mm	2.05"	52mm	50lb	22kg	LIGHT HEAVY
NT20048C	NT20048CB	7.99"	203mm	.181"	4.6mm	2.16"	55mm	50lb	22kg	
NT25048C	NT25048CB	9.84"	250mm	.189"	4.8mm	2.91"	74mm	50lb	22kg	
NT29548C	NT29548CB	11.02"	280mm	.189"	4.8mm	3.19"	81mm	50lb	22kg	HEAVY
NT29536C	NT29536CB	11.50"	292mm	.142"	3.6mm	3.35"	85mm	40lb	18kg	
NT37048C	NT37048CB	14.49"	368mm	.189"	4.8mm	4.02"	102mm	50lb	22kg	
NTA43248C	NTA43248CB	17.00"	432mm	.189"	4.8mm	4.92"	125mm	50lb	22.2kg	HEAVY
NT15076C	NT15076CB	5.91"	150mm	.299"	7.6mm	1.54"	39mm	120lb	54.5kg	
NT20076C	NT20076CB	7.99"	203mm	.299"	7.6mm	2.16"	55mm	120lb	54.5kg	
NT29076C	NT29076CB	11.02"	280mm	.299"	7.6mm	3.07"	78mm	120lb	54.5kg	HEAVY
NT37076C	NT37076CB	14.96"	380mm	.299"	7.6mm	4.33"	110mm	120lb	54.5kg	
NT45090C	NT45090CB	17.72"	450mm	.315"	8.0mm	5.24"	133mm	120lb	54.5kg	
NT55090C	NT55090CB	21.65"	550mm	.315"	8.0mm	6.54"	166mm	175lb	80kg	HEAVY
NTA61090C	NTA61090CB	24.00"	610mm	.354"	9.0mm	7.28"	185mm	175lb	80kg	
NT76290C	NT76290CB	30.00"	762mm	.354"	9.0mm	9.29"	236mm	175lb	80kg	
NTA91490C	NTA91490CB	36.00"	914mm	.354"	9.0mm	10.63"	270mm	175lb	80kg	HEAVY
NTA121990C	NTA121990CB	48.00"	1219mm	.354"	9.0mm	14.96"	380mm	175lb	80kg	

Push Mount Cable Ties

- Material: UL approved NYLON 66, 94V-2
- Press the tie into a pre-drilled hole simple and secure one-piece harness tying and mounting.
- PARTS ARE PACKAGED 100 PIECES PER BAG • PURCHASE IN PACKAGED QUANTITIES ONLY

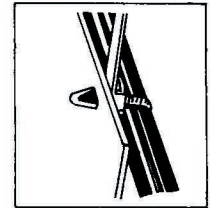
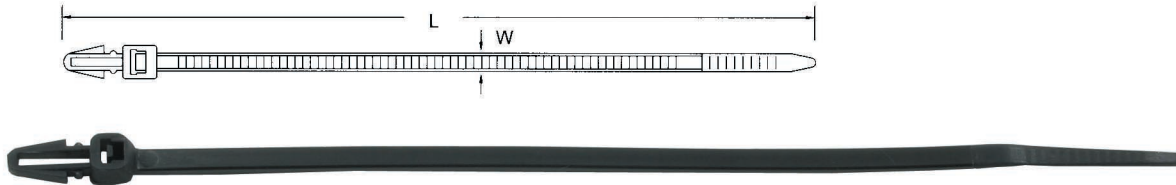

ITEM NO.		LENGTH		WIDTH		MAX. STRENGTH		DRILLED HOLE DIA.		MAX. PANEL THK.	
NATURAL	UV BLACK	STD	METRIC	STD	METRIC	STD	METRIC	STD	METRIC	STD	METRIC
NTA15535PMTG	NTA15535PMTGB	6.12"	155mm	.138"	3.5mm	40lb	18kg	.189"	4.8mm	.125"	3.2mm
NTA20347PMTG	NTA20347PMTGB	8"	203mm	.189"	4.8mm	50lb	22.2kg	.236"	6.0mm	.125"	3.2mm

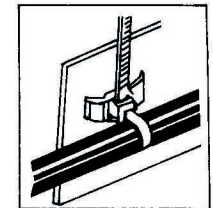
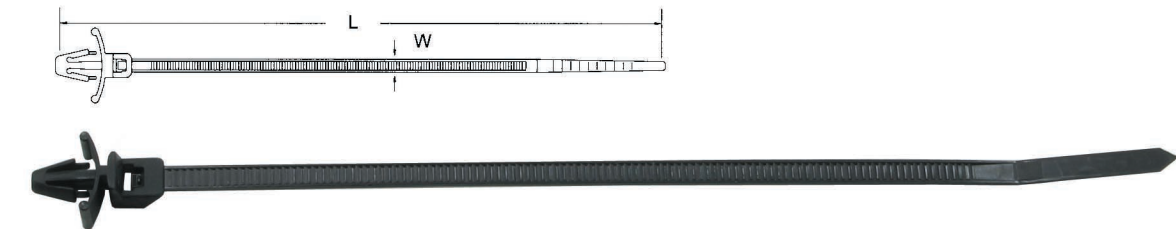

ITEM NO.		LENGTH		WIDTH		MAX. STRENGTH		MTG HOLE		MAX. PANEL THK.		MAX BUDLE DIA.	
NATURAL	UV BLACK	STD	METRIC	STD	METRIC	STD	METRIC	STD	METRIC	STD	METRIC	STD	METRIC
NTA11225WPM	NTA11225WPMB	4.41"	112mm	.098"	2.5mm	18lb	8kg	.157"	4.0mm	.070"	1.7mm	.98"	25mm
NTA15535WPM	NTA15535WPMB	6.10"	155mm	.138"	3.5mm	40lb	18kg	.157"	4.0mm	.070"	1.7mm	1.42"	36mm
NTA13048WPM	NTA13048WPMB	5.12"	130mm	.189"	4.8mm	50lb	22kg	.236"	6.0mm	.070"	1.7mm	1.18"	30mm
NTA20048WPM	NTA20048WPMB	7.87"	200mm	.189"	4.8mm	50lb	22kg	.236"	6.0mm	.070"	1.7mm	1.97"	50mm

Screw Mounting Cable Tie



- Material: UL approved NYLON 66, 94V-2
- The cable tie can be secured to panel with a single bolt.
- PARTS ARE PACKAGED 100 PIECES PER BAG • PURCHASE IN PACKAGED QUANTITIES ONLY

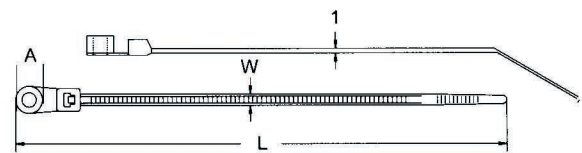

ITEM NO.		LENGTH		WIDTH		MAX. STRENGTH		HOLE DIAMETER		PACKAGING
NATURAL	UV BLACK	STD	METRIC	STD	METRIC	STD	METRIC	STD	METRIC	
NTA20542SMTG	NTA20542SMTGB	8.07"	205mm	.165"	4.2mm	50lb	8kg	.200"	5mm	100 pcs.

In Line Cable Tie

- Material: UL approved NYLON 66, 94V-2
- Flat headed low profile design to be used with playground equipment to avoid harming playing children.
- PURCHASE IN PACKAGED QUANTITIES ONLY

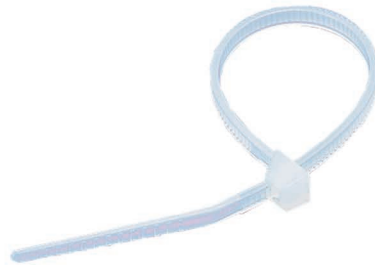
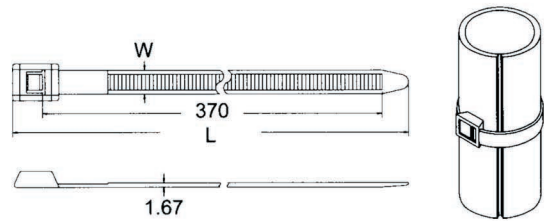

ITEM NO.	LENGTH		WIDTH		MAX STRENGTH		PACKAGING
	STD	METRIC	STD	METRIC	STD	METRIC	
NTA39190LC	15.39"	391mm	.354"	9mm	50lb	22kg	100 pcs.

Magic Cable Ties

- Material: Combination of Nylon and Polypropylene
- PURCHASE IN PACKAGED QUANTITIES ONLY

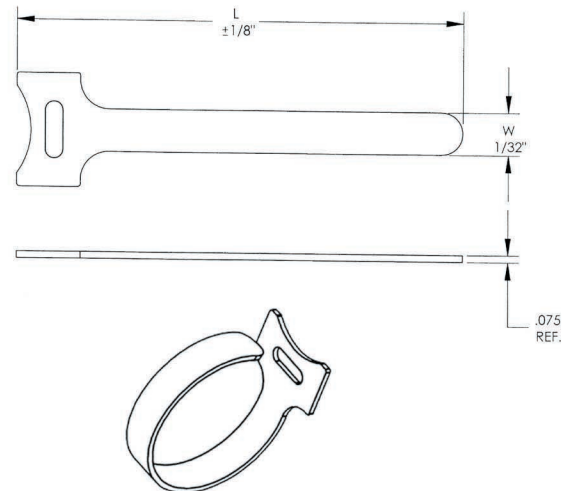

ITEM NO.	LENGTH		WIDTH		MAX. BUNDLE DIA		MAX STRENGTH		PACKAGING
	STD	METRIC	STD	METRIC	STD	METRIC	STD	METRIC	
NTA12512VM	4.92"	125mm	.472"	12mm	1.18"	30mm	40 lb	18kg	20 pcs.
NTA13512VM	5.32"	135mm	.472"	12mm	1.30"	33mm	40 lb	18kg	20 pcs.
NTA18012VM	7.09"	180mm	.472"	12mm	1.58"	40mm	40 lb	18kg	20 pcs.
NTA21016VM	8.27"	210mm	.630"	16mm	1.97"	50mm	40 lb	18kg	20 pcs.
NTA31016VM	12.20"	310mm	.630"	16mm	3.35"	85mm	40 lb	18kg	20 pcs.

Push Tie Mount

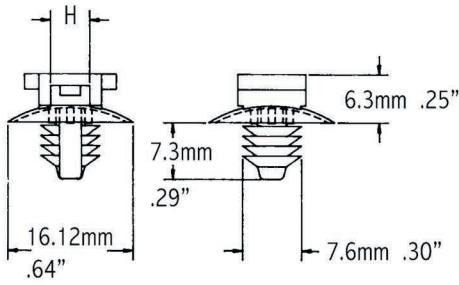

- Material: UL approved NYLON 66, 94V-2
- Drill .244" (6.2mm) hole on board to fix tie mount and then insert tie into the mount for bundling cables.
- PURCHASE IN PACKAGED QUANTITIES ONLY

ITEM NO.	T		FITTING		PACKAGING
	STD	METRIC	STD	METRIC	
NM23PM25	.197"	5mm	.299"	7.6mm	100 pcs.

Locking Wire Saddle

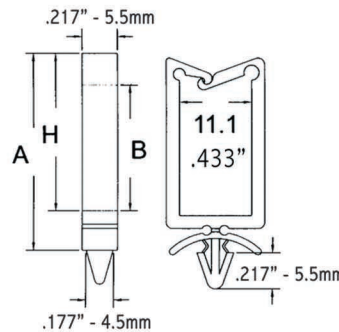
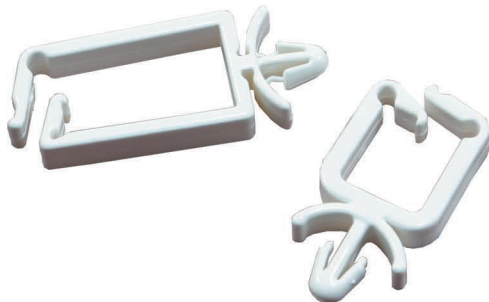

DRAWING X

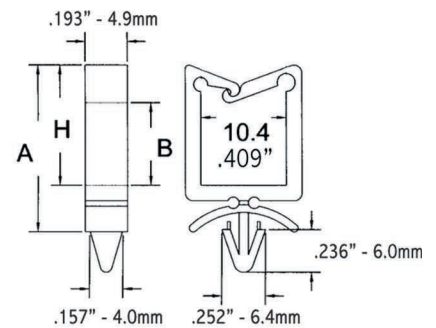

DRAWING Y

- Material: UL approved NYLON 66, 94V-2
- For directing and gathering cables at low cost.
- Locking into 4.8mm diameter mounting hole with fingertip pressure.
- Self adjust to various panel thickness
- PACKAGED 100 PCS. PER BAG • PURCHASE IN PACKAGED QUANTITIES ONLY

ITEM NO.	H		A		B		MAX PANEL THK.		DRAWING	PACKAGING
	INCH	METRIC	INCH	METRIC	INCH	METRIC	INCH	METRIC		
NM22LWS00	.362"	9.2mm	.500"	12.7mm	.110"	2.8mm	.091"	2.3mm	X	100 pcs.
NM22LWS01	.567"	14.4mm	.705"	17.9mm	.339"	8.6mm	.091"	2.3mm	X	100 pcs.
NM22LWS02	.921"	23.4mm	1.059"	26.9mm	.717"	18.2mm	.091"	2.3mm	X	100 pcs.
NM22LWS2L	.618"	15.7mm	.709"	18.0mm	.492"	12.5mm	.146"	3.7mm	Y	100 pcs.
NM22LWS03	1.232"	31.3mm	1.370"	34.8mm	1.03"	26.2mm	.091"	2.3mm	X	100 pcs.

Flat Cable Clamp

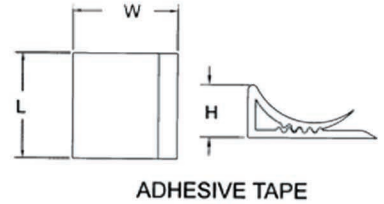
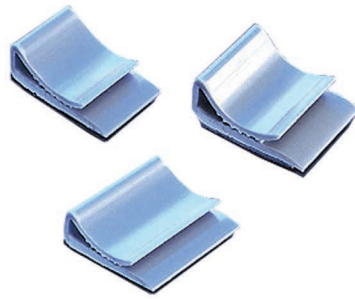

- Made of finest PVC backed with quality adhesive tape.
- For routing flat cable neatly and firmly.
- Insert your cable into the clamp and your job is done.
- Color: Grey
- PACKAGED IN BAGS OF 100 PIECES EACH • PURCHASE IN PACKAGED QUANTITIES ONLY

ITEM NO.	LENGTH		WIDTH		HEIGHT		PACKAGING
	INCH	METRIC	INCH	METRIC	INCH	METRIC	
NM22FCC0591	.591"	15mm	.984"	25mm	.394"	10mm	100 pcs
NM22FCC0787	.787"	20mm	.984"	25mm	.394"	10mm	100 pcs
NM22FCC0984	.984"	25mm	.984"	25mm	.394"	10mm	100 pcs
NM22FCC1102	1.10"	28mm	.984"	25mm	.394"	10mm	100 pcs

Adjustable Cable Clamp

- Material: UL approved Black NYLON 66, 94V-2 (Backed with adhesive tape)
- One size of adjustable clamp can accommodate various cables that will save your stock cost.
- Easy to install, and open and close for unlimited usage
- Color: Black

- PACKAGED IN BAGS OF 100 PIECES EACH
PURCHASE IN PACKAGED QUANTITIES ONLY

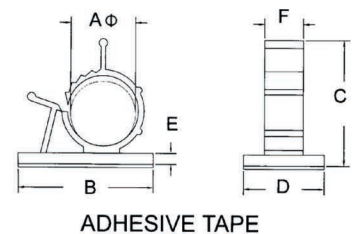

ITEM NO.	A		B		C		D		E		F	
	INCH	METRIC	INCH	METRIC	INCH	METRIC	INCH	METRIC	INCH	METRIC	INCH	METRIC
NM22ACC0375	.311/.406"	7.9/10.3mm	1.00"	25.4mm	.874"	22.2mm	.752"	19.1mm	.063"	1.6mm	.402"	10.2mm
NM22ACC0437	.394/.492"	10.0/12.5mm	1.252"	31.8mm	1.094"	27.8mm	.752"	19.1mm	.063"	1.6mm	.402"	10.2mm
NM22ACC0562	.496/.606"	12.6/15.4mm	1.500"	38.1mm	1.252"	31.8mm	.752"	19.1mm	.063"	1.6mm	.500"	12.7mm
NM22ACC0750	.650/.791"	16.5/20.1mm	1.654"	42mm	1.752"	44.5mm	1.00"	25.4mm	.063"	1.6mm	.500"	12.7mm
NM22ACC0938	.874/1.00"	22.2/25.4mm	1.654"	42mm	1.752"	44.5mm	1.00"	25.4mm	.063"	1.6mm	.500"	12.7mm

Ladder Style Adjustable Cable Clamp

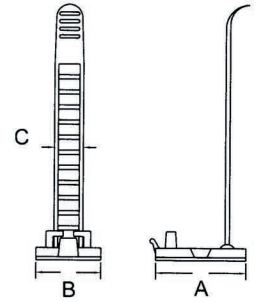

- Material: UL approved Natural NYLON 66, 94V-2
- PACKAGED IN BAGS OF 100 PIECES EACH • PURCHASE IN PACKAGED QUANTITIES ONLY

ITEM NO.	A		B		C		MAX. BUNDLE DIA.		PACKAGING
	NATURAL	INCH	METRIC	INCH	METRIC	INCH	METRIC	INCH	
NM22LCC0625	.984"	25mm	.709"	18mm	.311"	7.9mm	.669"	17.0mm	100 pcs
NM22LCC0812	1.200"	30.5mm	.827"	21mm	.472"	12mm	.866"	22.0mm	100 pcs
NM22LCC1000	1.200"	30.5mm	.827"	21mm	.472"	12mm	1.024"	26.0mm	100 pcs

Cable Gland

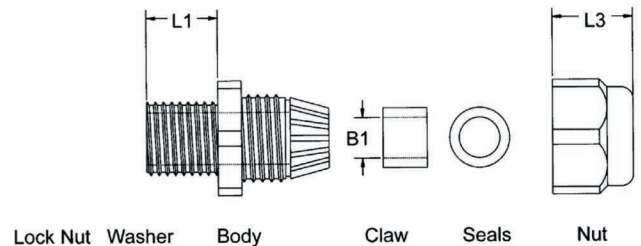

- Material: UL approved Black NYLON 66, 94V-2
- PURCHASE IN PACKAGED QUANTITIES ONLY

NPT-THREAD SEE MICRO PLASTICS' HEX JAM NUTS PJN SERIES FOR HEX NUTS, SOLD SEPERATE

ITEM NO.	NPT THREAD		B1		L1		L3		CABLE RANGE	PACKAGING	
	BLACK	INCH	INCH	METRIC	INCH	METRIC	INCH	METRIC			
NM23CG0250	NPT	1/4"	.236"	6mm	.299"	7.6mm	.520"	13.2mm	.118-.256"	3-6.5mm	50 pcs
NM23CG0375	NPT	3/8"	.354"	9mm	.575"	14.6mm	.661"	16.8mm	.197-.394"	5-10mm	50 pcs
NM23CG0500	NPT	1/2"	.500"	12.7mm	.492"	12.5mm	.724"	18.4mm	.394-.551"	10-14mm	50 pcs
NM23CG0750	NPT	3/4"	.650"	16.5mm	.575"	14.6mm	.878"	22.3mm	.512-.709"	13-18mm	50 pcs
NM23CG1000	NPT	1"	.933"	23.7mm	.579"	14.7mm	1.071"	27.2mm	.709-.984"	18-25mm	25 pcs
NM23CG1250	NPT	1-1/4"	1.142"	29mm	.705"	17.9mm	1.236"	31.4mm	.866-1.260"	22-32mm	10 pcs

Closed End Wire Connectors

- Material: UL approved NYLON 66, 94V-2
- Nylon insulated close-end wire connector
- To apply, insert pre-stripped wires into connector tube and crimp it with crimping tool to hold wires firmly even in vibration

PURCHASE IN PACKAGED QUANTITIES ONLY

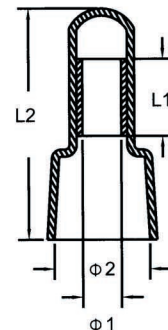

E116091



LR97798

ITEM NO.	L1		L2		1		2		PACKAGING	
	NATURAL	INCH	METRIC	INCH	METRIC	INCH	METRIC	INCH		METRIC
NM22WC01	.295"	.295"	7.5mm	.787"	.787"	20mm	.094"	.307"	7.8mm	100 pcs
NM22WC02	.295"	.295"	7.5mm	.787"	.787"	20mm	.118"	.307"	7.8mm	100 pcs
NM22WC05	.335"	.335"	8.5mm	.996"	.996"	25.3mm	.150"	.413"	10.5mm	100 pcs
NM22WC08	.374"	.374"	9.5mm	1.071"	1.071"	27.2mm	.185"	.472"	12.0mm	100 pcs

Screw On Wire Connectors

- Material: PVC Shell with spring inserted
- Strip wires before application

PARTS ARE PACKAGED 100 PIECES PER BAG • PURCHASE IN PACKAGED QUANTITIES ONLY

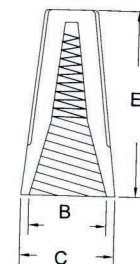

ITEM NO.	COLOR	B		C		E		WIRE COMBINATION	
		INCH	METRIC	INCH	METRIC	INCH	METRIC	MINIMUM	MAXIMUM
NM22SWC71	Grey	.256"	6.5mm	.343"	8.7mm	.591"	15mm	MIN#20X1+#22X1	MAX#16X2
NM22SWC72	Blue	.295"	7.5mm	.394"	10.0mm	.709"	18mm	MIN#20X3	MAX#16X3
NM22SWC73	Orange	.374"	9.5mm	.441"	11.2mm	.906"	23mm	MIN#20X3	MAX#16X3+#18X1
NM22SWC74	Yellow	.425"	10.8mm	.551"	14.0mm	.953"	24.2mm	MIN#14X1+#18X1	MAX#14X4+#18X1
NM22SWC76	Red	.500"	12.7mm	.661"	16.8mm	1.079"	27.4mm	MIN#14X2	MAX#10X2+#12X2

Nail In Cable Clips (Single, Round Cable)

Molded Nail-In Cable Clips are used to safely install cable T.V., fiber optics, computer networks, telephone and other communication systems, hydraulic and pneumatic systems. The clips are molded in tough, electrically insulating, ultra violet resistant, high density Polyethylene. Main stress areas of the clip have reinforcing ribs designed into the part to strengthen and absorb the impact. The Nail-InClips have all contact edges radiused to protect cable or tubing from damage. Clips are supplied with heat treated, galvanized steel nails pre-assembled, ready for use in masonry, wood, plaster, or stucco. Clips are easily and efficiently installed, resulting in a low in-place cost. Nail-In Clips are stocked in the most popular cable sizes ranging from 4mm to 9mm including the RG59 and the double shield cables.

Material: Polyethylene (Black, White)

With nails inserted

PURCHASE IN PACKAGED QUANTITIES ONLY

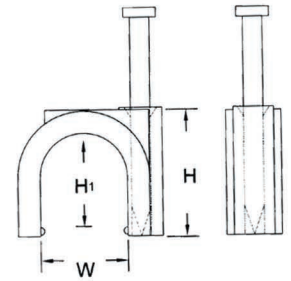

ITEM NO.		W		H		H 1		PACKAGING
BLACK	WHITE	INCH	METRIC	INCH	METRIC	INCH	METRIC	
22NCC0400R	22NCC0400RW	.157"	4mm	.260"	6.6mm	.165"	4.2mm	100 pcs
22NCC0500R	22NCC0500RW	.100"	5mm	.299"	7.6mm	.209"	5.3mm	100 pcs
22NCC0700R	22NCC0700RW	.236"	6mm	.354"	9mm	.260"	6.6mm	100 pcs
22NCC0800R	22NCC0800RW	.315"	8mm	.453"	11.5mm	.339"	8.6mm	100 pcs

Nail In Cable Clips (Single, Flat Cable)

Material: Polyethylene (Black, White)

With nails inserted

PURCHASE IN PACKAGED QUANTITIES ONLY

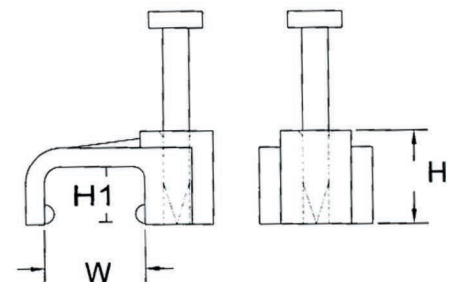

ITEM NO.		W		H		H 1		PACKAGING
BLACK	WHITE	INCH	METRIC	INCH	METRIC	INCH	METRIC	
22NCC0450F	22NCC0450FW	.217"	5.5mm	.217"	5.5mm	.122"	3.1mm	100 pcs
22NCC0900F	22NCC0900FW	.335"	8.5mm	.315"	8mm	.205"	5.2mm	100 pcs

Nail In Cable Clips (Double)

- Material: Polyethylene (Black, White)
- Double nail ensures cable will firmly stay in place
- With nails inserted
- PURCHASE IN PACKAGED QUANTITIES ONLY

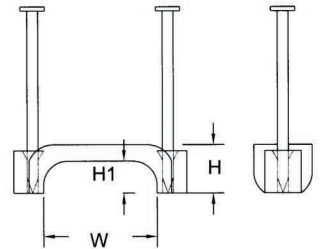

ITEM NO.	W		H		H 1		PACKAGING	
	BLACK	WHITE	INCH	METRIC	INCH	METRIC		INCH
22NCC1250FB	22NCC1250FW	.492"	12.5mm	.315"	8mm	.209"	5.3mm	100 pcs
22NCC1900FB	22NCC1900FW	.736"	18.7mm	.315"	8mm	.209"	5.3mm	100 pcs

Split Loom

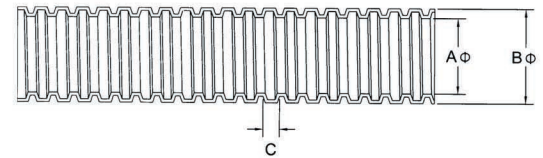

- Material: Polypropylene (Black)
- PRODUCT IS PACKAGED IN 100 FT. ROLLS • PURCHASE IN PACKAGED QUANTITIES ONLY

SPLIT DESIGN

ITEM NO.	SIZE	A +/- .016" 0.4mm		B +/- .016" 0.4mm		C		PACKAGING
		INCH	METRIC	INCH	METRIC	INCH	METRIC	
NM22SL0250	1/4"	.291"	7.4mm	.402"	10.2mm	.102"	2.60mm	100 ft. roll
NM22SL0375	3/8"	.421"	10.7mm	.630"	16.0mm	.130"	3.30mm	100 ft. roll
NM22SL0500	1/2"	.543"	13.8mm	.689"	17.5mm	.122"	3.10mm	100 ft. roll
NM22SL0625	5/8"	.591"	15.0mm	.768"	19.5mm	.138"	3.50mm	100 ft. roll
NM22SL0750	3/4"	.760"	19.3mm	.937"	23.8mm	.138"	3.50mm	100 ft. roll
NM22SL1000	1"	.957"	24.3mm	1.260"	32.0mm	.142"	3.61mm	100 ft. roll

Snap Latch

Material: UL approved NYLON 66, 94V-2

Not assembled

PARTS ARE PACKAGED 100 PIECES PER BAG • PURCHASE IN PACKAGED QUANTITIES ONLY

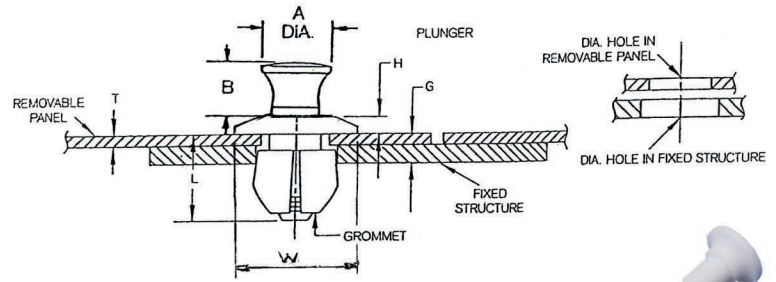

UNTOLERANCED DIMENSIONS +/- .010

ITEM NO.	GROMMET						HOLE DIA.		PLUNGER	
	SHEET CAPACITY			H	L	W DIA.	Removable Panel	Fixed Structure	A	B
	T MAX	G MIN.	G MAX.							
NM27SL0809	.065"	.084"	.173"	.06"	.38"	.335"	.242" - .238"	.254" - .250"	.28"	.10"
	1.6mm	2.1mm	4.4mm	1.5mm	9.6mm	8.5mm	6.15mm - 6.04mm	6.45mm - 6.35mm	7.1mm	2.5mm
NM27SL0810	.065"	.084"	.173"	.06"	.38"	.335"	.242" - .238"	.254" - .250"	.32"	.27"
	1.6mm	2.1mm	4.4mm	1.5mm	9.6mm	8.5mm	6.15mm - 6.04mm	6.45mm - 6.35mm	8.1mm	6.8mm
NM27SL1010	.098"	.118"	.207"	.062"	.44"	.425"	.299" - .294"	.323" - .316"	.36"	.25"
	2.5mm	3.0mm	5.2mm	1.6mm	11.2mm	10.8mm	7.59mm - 7.47mm	8.20mm - 8.03mm	9.2mm	6.4mm

Open/Close Bushings

- Material: UL approved HEAT STABILIZED NYLON , 94V-2 (Black)
- Protect wire cable tubing and hose from sharp, uneven drilled or punched holes in sheet metal.
- For 1/32" - 0.8mm to 1/8" - 3.2mm chassis thickness.
- Finger-tip pressure to install. No tool is needed.
- Can be applied after power cable was installed.

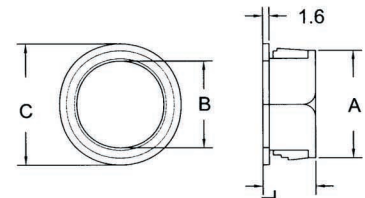
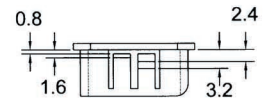

PARTS ARE PACKAGED 100 PIECES PER BAG • PURCHASE IN PACKAGED QUANTITIES ONLY

ITEM NO.	MOUNTING HOLE A		B		C		L		PACKAGING
	INCH	METRIC	INCH	METRIC	INCH	METRIC	INCH	METRIC	
NM22OCB0375	3/8"	9.5mm	.264"	6.7mm	.421"	10.7mm	.406"	10.3mm	100 pcs.
NM22OCB0500	1/2"	12.7mm	.315"	8.0mm	.559"	14.2mm	.406"	10.3mm	100 pcs.
NM22OCB0625	5/8"	15.9mm	.453"	11.5mm	.697"	17.7mm	.406"	10.3mm	100 pcs.
NM22OCB0750	3/4"	19.0mm	.516"	13.1mm	.795"	20.2mm	.406"	10.3mm	100 pcs.
NM22OCB0875	7/8"	22.2mm	.669"	17.0mm	.921"	23.4mm	.406"	10.3mm	100 pcs.
NM22OCB1000	1"	25.5mm	.795"	20.2mm	1.063"	27.0mm	.406"	10.3mm	100 pcs.

Wiring Duct (open slot)

- Material: High impact, self-extinguishing, warp-proof PVC (Polyvinyl chloride)
- Color: Grey
- Maximum service temperature: 50°C
- These devices are for routing of wires within devices in factory installations where the suitability of use will be determined by UL during the end use investigation.
- Features parallel holes on both sidewalls to facilitate cutting in wire application.

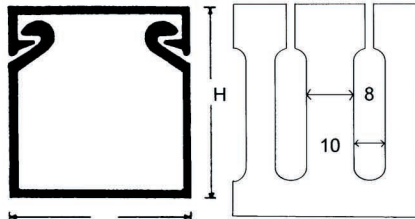
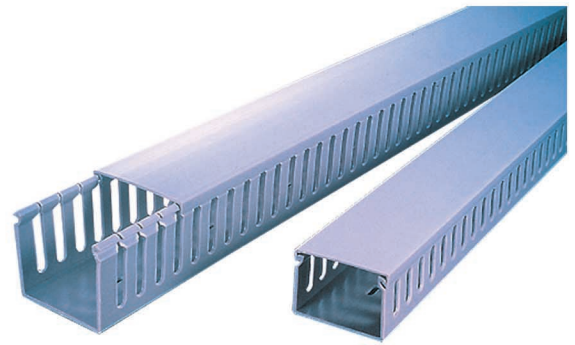

*SLOT DIMENTION APPLIES TO THE SLOTTED DUCT ONLY



ITEM NO.		SLOT*		WIDTH		HEIGHT		WIRES TO BE CONTAINED	LENGTH
SOLID DUCT	SLOTTED DUCT	INCH	METRIC	INCH	METRIC	INCH	METRIC		
NM27WDS05L	NM27WDM05L	.315"	8mm	.5"	15mm	1"	25mm	5-12 pcs	2m
NM27WDS07L	NM27WDM07L	.315"	8mm	.75"	20mm	.75"	20mm	5-12 pcs	2m
NM27WDS0L	NM27WDM0L	.315"	8mm	1"	25mm	1"	25mm	10-25 pcs	2m
NM27WDS67L	NM27WDM67L	.315"	8mm	2"	48mm	4"	100mm	215-250 pcs	2m

Wiring Duct (open slot)

- Material: High impact, self-extinguishing, warp-proof PVC
- Color: Grey
- Test to UL file E97527 up to 50°C
- These devices are for routing of wires within devices in factory installations where the suitability of use will be determined by UL during the end use investigation.
- Maximum service temperature: 85°C
- Features parallel holes on both sidewalls to facilitate cutting wire in application.

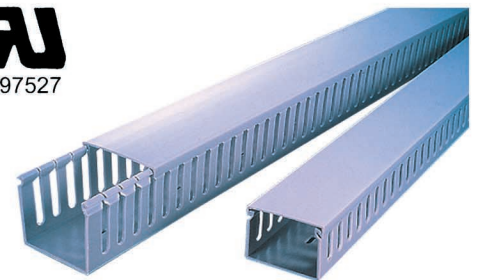
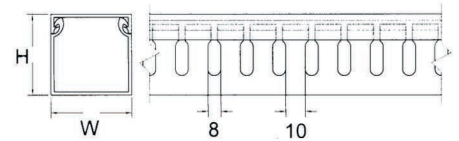

*SLOT DIMENTION APPLIES TO THE SLOTTED DUCT ONLY

ITEM NO.		SLOT*		WIDTH		HEIGHT		WIRES TO BE CONTAINED	LENGTH
SOLID DUCT	SLOTTED DUCT	INCH	METRIC	INCH	METRIC	INCH	METRIC		
NM27WDS1X2	NM27WDA1X2	.315"	8mm	1"	25mm	2"	50mm	20-25 pcs	2m
NM27WDS1X3	NM27WDA1X3	.315"	8mm	1"	25mm	3"	75mm	60-75 pcs	2m
NM27WDS1.5X1	NM27WDA1.5X1	.315"	8mm	1.5"	38mm	1"	25mm	20-23 pcs	2m
NM27WDS1.5X2	NM27WDA1.5X2	.315"	8mm	1.5"	38mm	2"	50mm	60-70 pcs	2m
NM27WDS2X2	NM27WDA2X2	.315"	8mm	2"	50mm	2"	50mm	80-90 pcs	2m
NM27WDS2X3	NM27WDA2X3	.315"	8mm	2"	50mm	3"	75mm	180-200 pcs	2m
NM27WDS3X3	NM27WDA3X3	.315"	8mm	3"	75mm	3"	75mm	200-250 pcs	2m
NM27WDS3X4	NM27WDA3X4	.315"	8mm	3"	75mm	4"	100mm	240-300 pcs	2m